

Cremax Europe GmbH
 Weidenweg 21H
 47059 Duisburg, Germany
 Email: support@icydock.com



Scan the QR code for more product information

Copyright © ICY DOCK International. All Rights Reserved. 650301 VER 1.0

1

Package Contents • Packungsinhalt • Contenu • Contenido del paquete
 • 包装について • 包装説明 • 包装说明

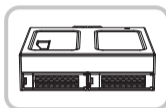

Device



User Manual



10 x M3*2.5 Pan Head Screw for Device
 (2 x Screw for Spare Parts)



10 x M3*4 Flat Head Screw for 2.5" SSD
 (2 x Screw for Spare Parts)

Note : Please use the included screws to secure the drive(s)

2

Device Information • Geräteinformationen • Informations dispositif
 • Información del dispositivo • 本体説明 • 機體説明 • 机体说明

▼ Front View

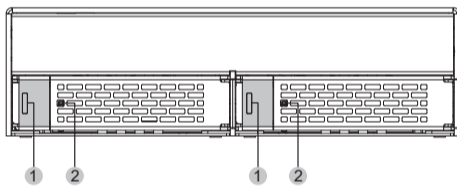

- 1 Drive Tray Ejection Button
- 2 LED Indicator (Power : Solid Green ; Drive Access : Flashing Green)

▼ Rear View

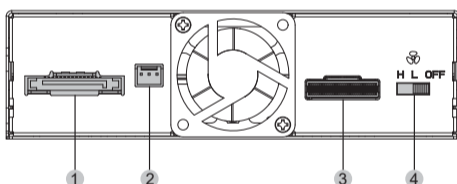

- 1 15 Pin SATA Power
- 2 3 Pin Fan Header Port
- 3 SlimSAS Connector (SFF-8654)
- 4 Fan Speed Controls

3

Installation Guide • Installationsanleitung • Guide d'installation • Guía de instalación
 • 製品の組み込み手順について • 操作步驟 • 操作步驟

3-1

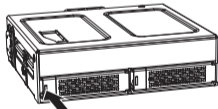

3-2

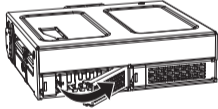

3-3

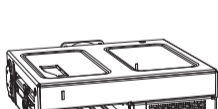

3-4

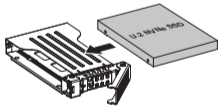

The tray accommodates U.2 NVMe drives up to 15mm in height. Flip both tray and drive to the bottom side to insert the drive.

3-5

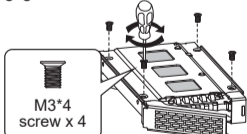

Align the four screw holes to the drive and use the included M3*4 screws to install.

3-6

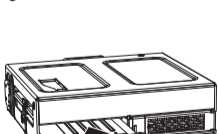

4

Device Installation • Installation eines Gerätes • Installation du dispositif
 • Instalación del dispositivo • デバイス取付手順 • 装置安裝步驟
 • 设备安装步驟

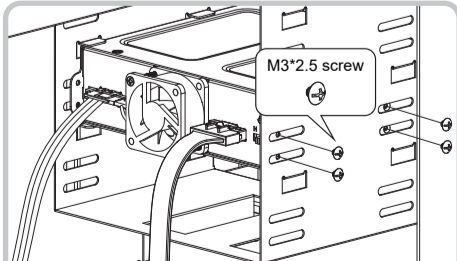

- 1. Insert the device into external 5.25" bay and use the included M3*2.5 screws to secure the device.
- 2. Connect 15 Pin SATA power and SlimSAS cables to the device to finish installation.

